

Securing wells for more than 90 years.

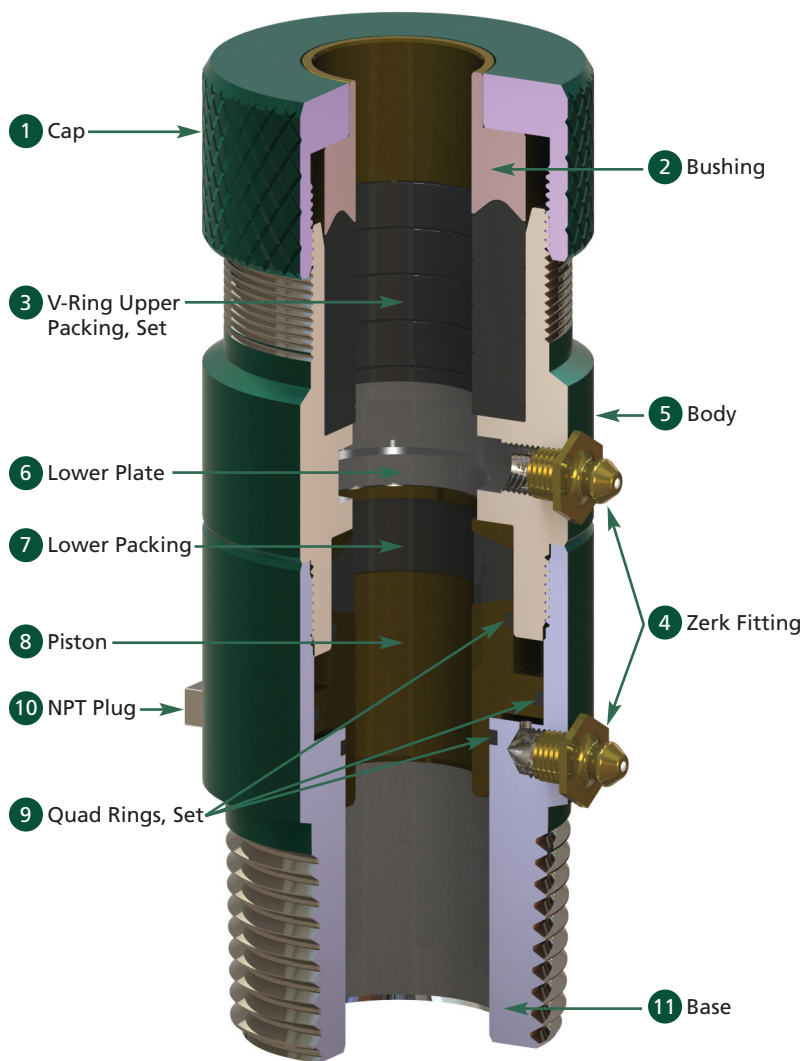

# Specification Sheet

## Stuffing Box



\*Double E has numerous Stuffing Box models with other configurations. Contact a Double E representative for your specific requirements. If we don't have an Stuffing Box model for your application, we can develop one for you.

### Key Features

- Small size allows for longer stroke length.
- Easily converts for H<sub>2</sub>S service by changing the packings and base.
- Double packing allows operator to change the upper packing while the well is still live.

### Key Rubber Properties

Temperature Range	Rubber Material
30 to 200°F	Nitrile
-30 to 300°F	HNBR
-15 to 450°F	Viton®

Viton® is a registered trademark of DuPont.

### Stuffing Box



### Popular Stuffing Boxes\*

Type	Description	Rod Size	Service	Working Pressure (PSI)	Model Number	Weight (lbs.)
PC	2-9/16" Flanged Base	1-1/2"	Standard	3,000	09-00887-1	12.5
PC	2-7/8" EU Base	1-1/2"	Standard	3,000	09-00325	12.5
PC	3" LP Base	1-1/2"	Standard	3,000	09-00425	12.5
PC	3-1/2" EU Base	1-1/2"	H <sub>2</sub> S	3,000	09-00835	12.5

# Replacement Parts for Popular Stuffing Box Models

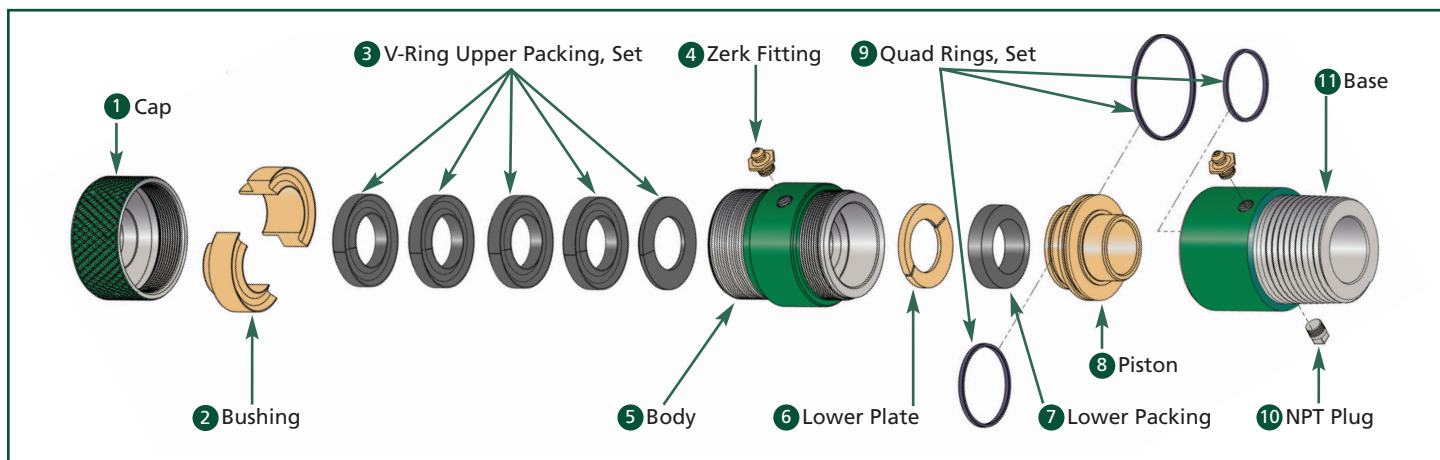

## Stuffing Box Main Components

Item	Description	Quantity	Part Number
1	Cap	1	09-01850
2	Bushing	1	See Below
3	V-Ring Upper Packing, Set	1	See Below
4	1/4" - 18 NPT Zerk Fitting	2	-
5	Body	1	09-01930
6	Lower Plate	1	09-02300
7	Lower Packing	1	See Below
8	Piston	1	09-01950
9	Quad Rings, Set	1	09-02320
10	1/4" - 18 NPT Plug	1	-
11	Base (2-3/8" EU)	1	09-02145

## Stuffing Box Bushing & Rubber Components

Size	Bushing	V-Ring Upper Packing, Set	Lower Packing	Rubber Material
1-1/2"	09-02100	09-01326	09-01675	Nitrile
1-1/2"	09-02100	09-01475	09-01785	HNBR
1-1/2"	09-02100	09-01485	09-01825	Viton®
1-1/4"	09-02050	09-01175	09-01625	Nitrile
1-1/4"	09-02050	09-01425	09-01745	HNBR
1-1/4"	09-02050	09-01478	09-01815	Viton®
1-1/8"	09-02050	09-01150	09-02250	Nitrile
1-1/8"	09-02050	09-01375	09-01725	HNBR

⚠ This brochure is intended as a guideline and reference. Appropriate testing and validation by users having technical expertise is necessary for proper use of Double E products.



Double E, Inc., 1261 Profit Drive, Dallas, Texas 75247  
214-631-2290 Fax 214-630-4712 [www.doubleeinc.com](http://www.doubleeinc.com)